

TILLAMOOK COUNTY SURVEYORS OFFICE

1/4 corner common to sections 16 and 17 T.3S.,R.10W.,W.M.

1/4
|
17+16
|
1970

I found a 1 1/4" iron rod with a 3" Tillamook County Surveyors brass cap, (see Tillamook County Surveyors rewitness card #613). I set a 10" cast iron monument case around the found iron rod with brass cap, and encased in concrete.

History of found Monument

I found this monument to be as reported on the above said rewitness, and the accessories found and/or set at that time to now be as follows:

24" hemlock S.88*29'E. 72.45', reported on rewitness as found remains; (Now just a mound of rot at position).

Power pole 121-BE S.72*W. 33.60'; (Found OK. New pole number is 178400).

Power pole 120-BE N.12*E. 138.80'; (Found PK nail in scribed triangle in power pole #178501 N.12*W. 138.78', Rewitness book 5 page 215 says N.12*W. also).

*14" hemlock N.79*E. 48.45'; (Found OK, now 28" hemlock face healed over and "do not cut tag attached.).

1 1/2" iron pipe West 30.00', Rewitness book 5 page 223; (Found very rusty 1 1/2" iron pipe at distance, 1.6' East of a fence corner, fence runs N-S-W).

*96" hat section post West 18.7'; (Found OK).

* Indicates yellow Tillamook County corner tag affixed.

Surveys and rewitnesses of reference not listed on card #613:

A-5205 1985 Allan E. Duncan L.S.793
A-4000 1979 Allan E. Duncan L.S.793
A-5422 1986 F.M. Gaylord L.S.929
A-2052 1970 John L. Carlich L.S.287
Field notebook "CT 17" page 53 1913 U.G. Jackson?
Rewitness book 5 page 215 1966 John L. Carlich.
Rewitness book 5 page 223 1964 W.E. Anderson?

Monument Location

This corner is located in approximately the centerline of Sandlake County road, 1/2 mile North of Galloway County Road junction, and 1/2 mile South of Cape Lookout County Road junction.

In the presence of Dan McNutt & Al Dvorak

September 20, 1990

Title

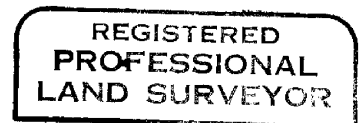
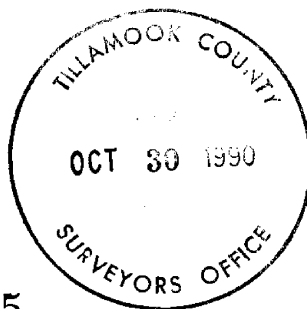

Allan E. Duncan C.S.

